

Material No:	111-7864	Rev:	A	Release/Change Authorization Number :	5094667	CONFIDENTIAL	
Description:	PARTS LIST ENVOY 36 [100J:EN]			Issue Date :	23/09/2014		
HAYTER					Supersedes :		
					Superseded By :		
					Created By :		TH
					Scale :		NONE
General Document							
THIS UNPUBLISHED DOCUMENT CONTAINS HAYTER CONFIDENTIAL AND PROPRIETARY INFORMATION. IT MAY NOT BE WHOLLY OR PARTIALLY COPIED, DISCLOSED TO OTHERS, OR USED FOR ANY PURPOSE WITHOUT WRITTEN PERMISSION FROM HAYTER. IF PUBLICATION OCCURS, THE FOLLOWING NOTICE APPLIES: © HAYTER ALL RIGHTS RESERVED.							
Reason for Revision:	RELEASE NEW, REPLACES OLD STYLE FILE AND DOFC (111-6960).						

Envoy 36 Electric - Spare Parts List

Original Version: EN

Issue : 12.06.14

Codes: 100J

From Serial: 315000001 and up

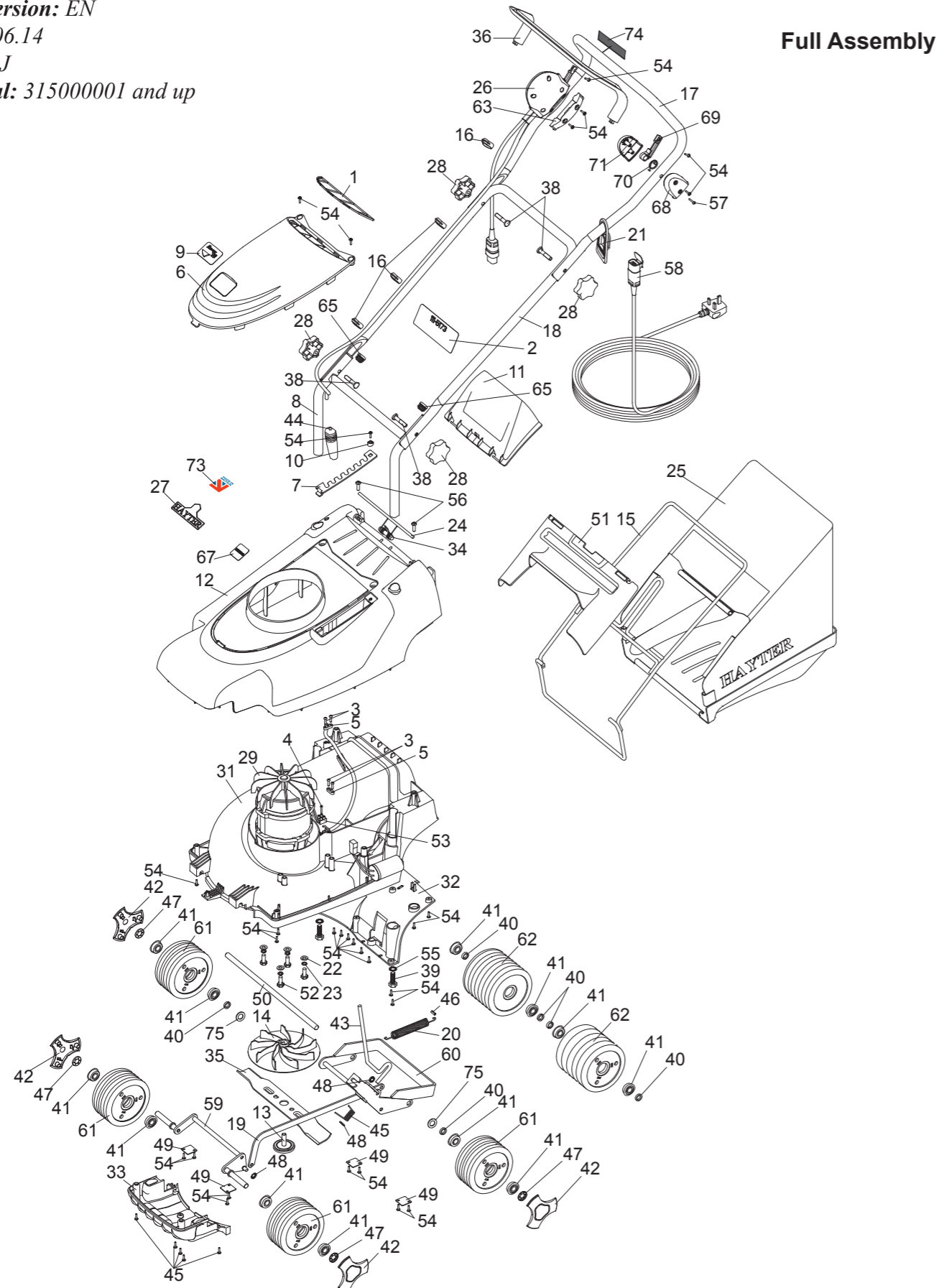

Full Assembly

Full Assembly

Item No	Description	Part No.	QTY	Item Note
1	VENT MESH ASM	111-0074	1	
2	DECAL-SAFETY ELECTRIC	111-5173	1	
3	SCREW	111-0094	4	
4	SCREW	111-0106	1	
5	CLAMP-CABLE	111-0117	2	
6	MOTOR COVER	111-0538	1	
7	PLATE-HOC	111-0539	1	
8	HANDLEBAR-LOWER	111-0540-03	1	
9	DECAL ENVOY ELECTRIC	111-4441	1	
10	COVER-SCREW HOC	111-0543	1	
11	DEFLECTOR-REAR	111-1042	1	
12	TOP COVER	111-1055	1	
13	BOLT-FIXING CUTTERBAR (NYLON)	100013	1	
14	CARRIER-CUTTERBAR	100014	1	
15	FRAME-GRASSBAG	100016-03	1	
16	CLIP-CABLE	100023	4	
17	HANDLEBAR-UPPER	100024	1	
18	HANDLEBAR-MIDDLE	100025-03	1	
19	ROD-CONNECTING	100037	1	
20	SPRING-COUNTER BALANCE	100080	1	
21	CLEAT-CABLE	100105	1	
22	WASHER	09475	4	
23	WASHER-SPRING	03469	4	
24	ROD-DEFLECTOR	100126	1	
25	GRASSBAG FABRIC AND BOTTOM ONLY	100513	1	
26	SWITCH AND LEAD ASSY	100515	1	
27	DECAL	410087	1	
28	KNOB-HANDLEBAR	480088	4	
29	MOTOR (1.4 Kw)	111-7714	1	
31	UNDERDECK	HY100003	1	
32	THROWPLATE	HY100004	1	
33	FINS	HY100006	1	
34	SPRING-DEFLECTOR	111-7417	1	
35	CUTTERBAR	HY100012	1	
36	ARM-BAIL	HY100017	1	
38	BOLT-HANDLEBAR	HY226024	4	
39	SCREW HH	09392	2	
40	SPACER-WHEEL, REAR	HY100030	6	
41	BEARING-WHEEL	HY100033	12	
42	HUB CAP	HY100036	4	
43	LEVER-HOC	HY100038	1	
44	KNOB-HOC	HY100039	1	
45	SPRING-HOC	HY100041	1	
46	PIN-SPRING HOC	HY100042	1	
47	WASHER-STARLOCK 12mm	HY100047	4	
48	WASHER-STARLOCK 8mm	0201086	3	
49	PLATE-PIVOT AXLE	HY100064	4	
50	ROD-AXLE REAR	HY100068	1	
51	TOP-GRASSBAG TOP	HY100075	1	
52	BOLT-MOTOR	HY100076	4	
53	BLOCK-TERMINAL	HY100077	1	
54	SCREW	HY100078	34	

Envoy 36 Electric - Spare Parts List

Full Assembly

Item No	Description	Part No.	QTY	Item Note
55	WASHER	HY100079	2	
56	SCREW-PPH THREAD FORMING	09687	2	
57	SCREW-PPH THREAD FORMING	HY100128	1	
58	MAIN LEAD	HY100135	1	
59	FRONT AXLE ASM	HY100503	1	
60	REAR AXLE ASM	HY100504	1	
61	WHEEL ASM	HY100505	4	
62	WHEEL ASSY WIDE	HY100506	2	
63	SWITCH LEFT LOWER	HY100021	1	
65	PLUG-TUBE	300160	2	
67	DECAL-HOC	320006	1	
68	MOUNT LEFT	100085	1	
69	LEVER MOUNT	HY100088	1	
70	SPRING BAILARM	HY100087	1	
71	MOUNT RIGHT	100086	1	
73	DECAL - MADE IN BRITAIN	111-7722	1	
74	DECAL, RESTARTING MOTOR	111-7418	1	
75	WASHER-PLAIN	ZWP1L000U	2	