

Material No:	<u>111-7888</u>	Rev:	A	Release/Change Authorization Number:	5095416	CONFIDENTIAL
Description:	MANUAL OPERATOR ENVOY 36 [100:EN]			Issue Date :	10/14/2014	
HAYTER Technical Publications Assembly	Supersedes:					
	Created By :				LH	
	Scale :				None	
	THIS UNPUBLISHED DOCUMENT CONTAINS HAYTER CONFIDENTIAL AND PROPRIETARY INFORMATION. IT MAY NOT BE WHOLLY OR PARTIALLY COPIED, DISCLOSED TO OTHERS, OR USED FOR ANY PURPOSE WITHOUT WRITTEN PERMISSION FROM HAYTER. IF PUBLICATION OCCURS, THE FOLLOWING NOTICE APPLIES: "HAYTER ALL RIGHTS RESERVED".					
Reason for Revision:	RELEASE TO PRODUCTION					

Comments

COVER PAGE FOR MANUAL OPERATOR ENVOY 36 [100:EN]



HAYTER
MAKERS OF THE FINEST MOWERS

Envoy 36 Electric
Code 100J

OWNER'S HANDBOOK



Original Version (EN)
Issued: 14/10/2014

From Serial Number: 31500001 Onwards
Part number: 111-7888 Rev A

CONTENTS

Introduction	3	Collection Without Grassbag	9
Safety Compliance	3	Heavy Growth	10
Main Features	4	Non Grassed Areas	10
Specifications	4	Safe Mower Practice	10
Safety Symbols	5	Overloading Protection	10
Safety Precautions	6 - 7	Maintenance Schedule	11
Safety Alert Symbol	6	Mower Maintenance	12 - 13
Training	6	Grassbag	12
Preparation	6	Deck Housing	12
Operation	6 - 7	Securing Nuts & Bolts	12
Maintenance & Storage	7	Lubrication	12
Assembling the Mower Before First Use	8	Cutterblade Removal	12
Delivery Checklist	8	Cutterblade Sharpening	13
Handlebar	8	Storage	13
Grassbag Assembly	8	Lawn Care Calendar	14
Grassbag Attachment	8	Trouble Shooting	15
Supply Cable	8	Warranty	16
Electrical Connection	8	EU Privacy Statement	17
Operating the Mower	9 - 10	Notes	17 - 19
Starting	9	Service Records & Customer Information	20
Forward Travel	9		
Turning	9		
Stopping	9		
Height of Cut	9		
Grassbag	9		

INTRODUCTION

Thank you for purchasing a Hayter mower. The following pages are designed to help you gain safe and efficient service from your machine.

IMPORTANT: This 'Owners Handbook' should be regarded as part of the mower as it gives essential information regarding mower safety, operation, maintenance and specifications. Read and understand this handbook prior to operating your mower for the first time. Make sure you are familiar with all the controls and points of regular maintenance. If you have any doubts, consult your local Hayter authorised dealer who will be pleased to give you assistance.

IMPORTANT: This mower is designed solely for use in a domestic grass cutting environment. Use in any other way is considered as contrary to the intended use. Compliance with and strict adherence to the conditions of operation, service and repair as specified in this handbook also constitute essential elements of the intended use.

This mower should be operated, serviced and repaired only by persons who are familiar with its particular characteristics and who are acquainted with the relevant safety procedures.

The safety precautions listed in this handbook and all other generally recognised regulations on safety must be observed at all times.

Use of non standard parts or any arbitrary modifications carried out on this machine may relieve Hayter Limited of liability for any resulting damage or injury. Hayter mowers are robustly constructed and designed for efficient economical performance under normal mowing conditions. Correct operation and maintenance will ensure a long and satisfactory service life. Prior to despatch from our factory every effort is made to ensure that your mower is delivered in perfect condition.

Throughout this handbook all references to **left** and **right** are as viewed from behind the handlebar, in the direction of forward travel.

This handbook is based on information available at the time of publication.

HAYTER LIMITED reserve the right to amend product specifications without prior notification.

Please be advised that the illustrations in this Handbook are generic and not specific to your product.

SAFETY COMPLIANCE

To ensure low noise and vibration levels, carry out the following procedures correctly:

- To prevent overloading the engine, use the correct height of cut and ground speed (where applicable).
- Follow the recommended maintenance instructions.
- Do not use your mower for prolonged periods of time.
- Always wear hearing protection.

VIBRATION INFORMATION

Hand / Arm Vibration Level at the Operator Position measured in accordance with European Standard EN ISO 5395:2013.

	100
Measured Vibration Level a _{hw}	3.2 ms ⁻²
Uncertainty of measurement K	1.6 ms ⁻²

SOUND PRESSURE INFORMATION

Sound Pressure Level at the Operator Position measured in accordance with European Standard EN ISO 5395:2013.

	100
Measured Sound Pressure Level L _{pA}	80 dB (A)
Uncertainty of measurement K	3 dB (A)

SOUND POWER INFORMATION

Sound Power Level measured in accordance with European Standard EN ISO 5395:2013.

	100
Measured Sound Power Level L _{wA}	85 dB (A)
Uncertainty of measurement K	2 dB (A)

For a full range of products and to locate your nearest authorised sales stockist, service or parts dealer please visit our website at www.hayter.co.uk

MAIN FEATURES

SPECIFICATIONS

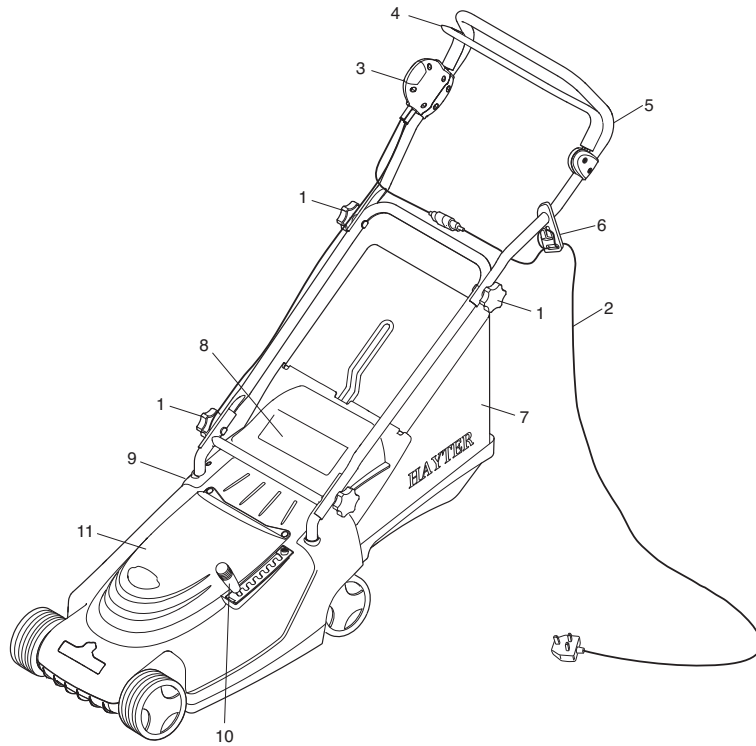

- | | |
|----------------------------|-------------------------|
| 1. Handlebar Securing Knob | 7. Grassbag Assembly |
| 2. Supply Cable | 8. Rear Deflector |
| 3. Switch Control | 9. Serial Number Label |
| 4. Motor Control Lever | 10. Height Of Cut Lever |
| 5. Handlebar | 11. Motor Housing |
| 6. Cable Cleat | |

Code	100
Weight	22 kg
Length	1360 mm
Width	405 mm
Height	1050 mm
Width of Cut	360 mm
Height of Cut (7 positions)	13 - 60 mm
Volts and Frequency	230V / 50 Hz
Power	1.4 kw
Cutterblade Speed	2950 rpm
Fuse Rating	13 amp

SAFETY SYMBOLS

Description: Safety alert be aware to the possibility of injury

Part Number: 111-0083



Description: Switch off and remove the plug from the mains before performing maintenance or repair work

Part Number: 111-5173



Description: Carefully read the Owners Handbook before using the machine

Part Number: 111-0083



Description: Danger of being hit by thrown objects

Part Number: 111-0083



Description: Keep bystanders at a safe distance from the mower

Part Number: 111-0083



Description: Danger of severing toes or fingers in cutting mechanism

Part Number: 111-0083



Description: Danger of electric shock. Do not cut cable

Part Number: 111-5173



Description: Danger of electric shock. Do not use in rain or wet weather

Part Number: 111-5173

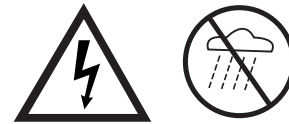

Description: Height of Cut

Part Number: 320006



Description: Switch ON / OFF

Part Number: 100515

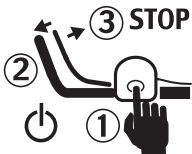

SAFETY PRECAUTIONS

Safety Alert Symbol

This safety alert symbol indicates important safety messages. When you see this symbol be alert to the possibility of injury. Carefully read the following and inform others.

Your mower is perfectly safe if used correctly. Failure to observe the following precautions may result in serious injury.

Training

Before using the mower read the owners handbook carefully. Pay particular attention to the safety precautions. Ensure that you are familiar with the controls and the proper use of the equipment. Learn how to stop the mower quickly in an emergency.

Never allow children or people unfamiliar with these instructions to use the mower. Local regulations can restrict the age of the operator.

Never mow while people, especially children, or pets are nearby.

Keep in mind that the user is responsible for accidents or hazards occurring to other people or their property.

All operators and mechanics should be trained. The owner is responsible for training users. Do not operate the machine under the influence of alcohol or drugs.

Preparation

It is recommended that a high sensitivity Residual Current Operated Circuit Breaker (RCCB) with a trip current of not more than 30 mA is installed at the mains socket. This will provide the user with additional protection against electric shock. The fuse installed in the plug only provides protection for the electrical equipment and will not safeguard against electrocution. Always check the RCCB before using the mower.

WARNING: Regularly inspect the supply cable for signs of damage or ageing. Replace immediately if defective.

While mowing, always wear substantial slip resistant footwear and long trousers. Do not operate the equipment when barefoot or wearing sandals.

Thoroughly inspect the area where the mower is to be used and remove all objects which may be thrown by the machine.

A damaged cutterblade or loose fixing bolt are major hazards. Before use, always visually inspect the cutting mechanism to ensure that it is in good condition. A damaged cutterblade must be replaced immediately with a genuine Hayter replacement part.

Do not tamper with or disable the mower safety systems, sealed adjusters or other features.

Before use, ensure that all starting interlocks and operator presence controls are properly functioning. Refer to Operating the Mower.

Operation

SWITCH OFF AND REMOVE PLUG FROM MAINS:

- Before clearing blockages or unclogging the discharge chute.
- Before cleaning/checking or working on the machine.
- Whenever you leave the machine.
- After striking a foreign object. Inspect the machine for damage and ensure necessary repairs are made before restarting and operating.
- If the machine starts to vibrate abnormally (check immediately).
- If the supply cable is entangled.

THE CUTTERBLADE CAN CONTINUE TO ROTATE AFTER THE MACHINE IS SWITCHED OFF.

Keep the supply cable clear of the cutterblade at all times.

Do not mow across the supply cable. If this occurs, disconnect the mains supply and check for damage. Do not use a defective supply cable.

Mow only in daylight or good artificial light.

Avoid using the machine on wet grass, where feasible.

Always be sure of your footing on slopes.

Walk, never run.

Do not operate the mower near drop-offs, ditches or embankments.

Do not mow excessively steep slopes of more than 20° and mow across the face of slopes, never up and down.

Exercise extreme caution when changing direction.

Use extreme caution when reversing or pulling the mower towards you.

Switch off the motor, if the mower has to be tilted for transportation when crossing surface other than grass and when transporting the mower to and from the area to be mowed.

Always replace worn or faulty parts with genuine Hayter parts.

Never operate the machine with defective guards, or without safety devices, for example deflectors and/or grass bag in place.

Do not put hands or feet near or under rotating parts.

SAFETY PRECAUTIONS

Operation continued

Do not tilt the front of the mower more than is absolutely necessary when starting.

Never lift the rear of the mower.

Never pick up or carry a mower whilst it is running or connected to the mains supply.

Do not lift the rear deflector whilst the motor is in operation, particularly when using it without a grassbag..

Maintenance & Storage

Keep all nuts, bolts and screws tight to ensure that the equipment is in safe operating condition.

Carefully examine the supply cable for signs of damage or ageing. Replace immediately if defective.

Check the rear deflector and grassbag frequently for wear or deterioration.

Replace worn or damaged parts for safety.

Wear strong work gloves when removing and reassembling the cutterblade.

This machine contains spring loaded assemblies which could cause a hazard when disassembled and re-assembled, this maintenance should only be carried out by a Hayter authorised dealer.

Lightning can cause severe injury or death. If lightning is seen or thunder is heard in the area, do not operate the mower; seek shelter.

ASSEMBLING THE MOWER BEFORE FIRST USE

Delivery Checklist

Remove the mower from the packaging and check that the following items have been supplied correctly. If any items are missing, contact your local Hayter dealer.

1. Engine Handbook
2. Grassbag Assembly
3. Parts List
4. Declaration of Conformity

To prevent accidents cut off the long ribbon attached to the grassbag and discard.

(Refer fig.1)

Handlebar

Unscrew the handlebar securing knobs sufficiently to allow the handlebar to pivot.

Unfold the handlebar to the operating position. Tighten all handlebar knobs to secure in position.

(Refer fig.2)

Take care to ensure that the power cable does not become snagged at the pivot points.

Grassbag Assembly

- Insert the metal frame into the grassbag fabric.
- Clip into position.
(Refer fig.3)
- Align and clip the top plastic cover into position.
(Refer fig.4)

Grassbag Attachment

Once the grassbag is assembled. Raise the rear deflector, pass the grassbag under the handlebar and hook into position. Lower the rear deflector to rest on the grassbag.

(Refer fig.5)

Supply Cable

Route the supply cable loosely across to the cable cleat on the left side of the handlebar. Make a loop in the supply cable and secure to the cable cleat.

(Refer fig.6)

Electrical Connection

Position the mower on the grass area to be cut. Carefully uncoil the supply cable clear of the mower. Ensure that the mains socket

is switched 'OFF' before connecting. Switch 'ON'.

Note: We recommend the use of a RCCB unit. Refer to the 'Safety Precautions - Preparation'.

Fig. 1

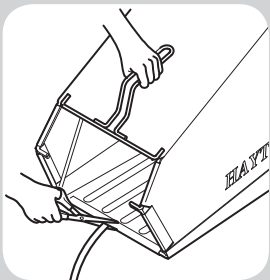

Fig. 2

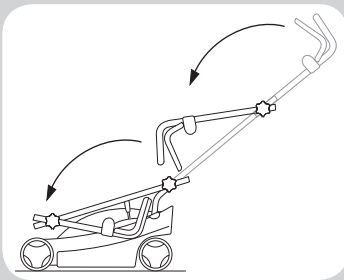

Fig. 3

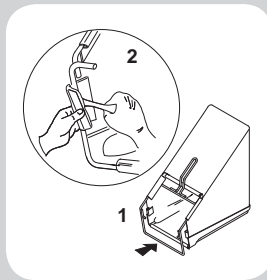

Fig. 4

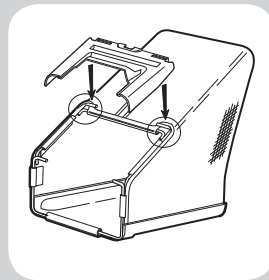

Fig. 5

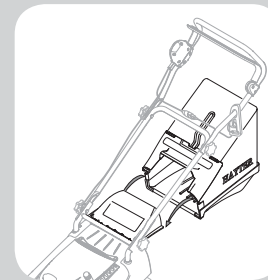
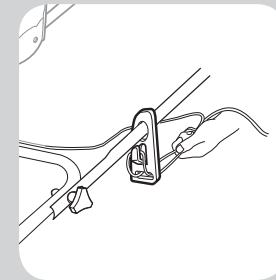

Fig. 6



OPERATING THE MOWER

Starting

If you restart the motor after it has been running but before it has come to a complete stop, you could damage the motor making the mower unsafe.

Allow the motor to come to a complete stop before starting it.

Locate the motor control lever mounted on the handlebar and ensure that your feet are clear of the mower deck. Depress the safety button with the right hand and pull the motor control lever towards the handlebar with the left hand. The motor will now start.

(Refer fig.7)

Forward Travel

Hold and push against the handlebar with both hands to move the mower forwards.

(Refer fig.8)

Turning

To make a wide turn steer the mower with the handlebar in the direction required.

To make a tight turn apply downward pressure on the handlebar

to raise the front wheels just above ground level and steer in the required direction.

To prevent accidents do not raise the front of the mower excessively when making a turn. Never raise the rear of the mower when the motor is running.

Stopping

Release the motor control lever to stop the motor.

WARNING: AVOID ACCIDENTS - The cutterblade may continue to rotate after the mower is switched off.

(Refer fig.9)

Height Of Cut

Move the height of cut lever sideways to disengage it from the locking notch, then push forward to lower or pull backward to raise the height of cut. Release the lever in the required position and ensure that it locks firmly into one of the seven notch settings.

Always select a height of cut to suit operating conditions. Prevent motor overloading and blockages by avoiding low cuts in long grass conditions. Be prepared to make two cuts when the grass is long.

(Refer fig.10)

Before Mowing

To prevent accidents, thoroughly inspect the area and remove all objects which when contacted by the mower cutterblade could become dangerous projectiles. Inspect the area for hidden obstructions which when contacted by the cutterblade could risk health and safety or result in damage to the mower. Remember the location of these obstructions and ensure that you mow around them.

(Refer fig.11)

Grassbag

Raise the rear deflector and lift the grassbag and lower the rear deflector to rest against the rear of the mower.

To empty the grassbag, pour out the grass clippings and shake the grassbag vigorously to clean the airways. Good grass collection depends on good air flow through the grassbag. When collecting grass clippings it is important that the grassbag is emptied regularly to prevent blockages and motor overloading.

(Refer fig.12)

Collection Without Grassbag

Remove the grassbag and operate the mower with the rear deflector in the closed position.

(Refer fig.13)

Fig. 7

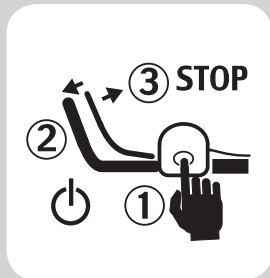

Fig. 8

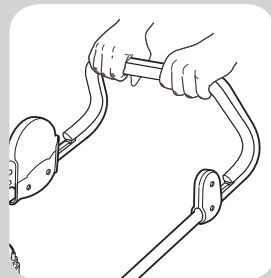

Fig. 9

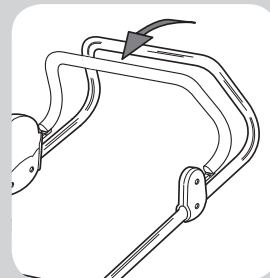

Fig. 10

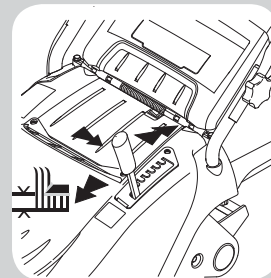

Fig. 11



Fig. 12

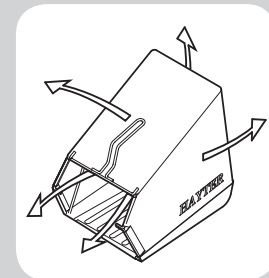
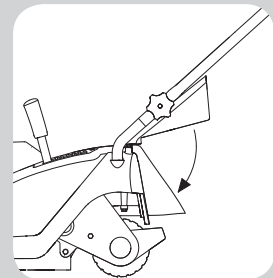

Fig. 13



OPERATING THE MOWER

Heavy Growth

Areas of heavy growth should be mown without collecting the clippings. If collection is required, first mow the area without the grassbag at the maximum height of cut setting. Allow the grass clippings to dry out and then mow the area at the maximum height of cut setting with the grassbag fitted. Reduce the height of cut and mow the area again as necessary until the required finish is obtained.

To prevent damage to your lawn do not remove more than one third of grass height in one cut.

(Refer fig.14)

Non Grassed Areas

When moving the mower across non-grassed areas, stop the motor and set the mower to the maximum height of cut to protect the cutting mechanism.

Safe Mower Practice

WARNING: PREVENT ACCIDENTS

Take extreme care not to mow across the supply cable. If this should occur, switch off immediately and disconnect the plug from the power supply. Carefully examine the cable for cuts and damage. A defective cable must be replaced before the mower is used again. Always be aware of the location of the supply cable in relation to the mower and the grass area. Do not allow the

cable to become hidden in uncut grass. Keep the cable over the cut area at all times. A cable which is out of sight, is out of mind and this could lead to a hazardous situation.

Plan a 'cutting scheme' which works away from the power supply point and ensures that the cable is trailed out over the cut area. Work up and down the lawn in rows. Turn the machine round at the end of the row and step across the cable so that the cable is trailed along in the cut area on the return run.

When working around flower beds, prevent the cable from trailing across cultivated area by positioning a stake at the corner of the bed. Do not allow the cable to be pulled around sharp obstructions. Stop mowing immediately if cable resistance is felt and remove the obstruction. Do not allow the cable to become entangled.

WARNING: PREVENT ACCIDENTS - Switch off at the mains, remove the plug before adjusting, cleaning or if the cable is entangled.

Overloading Protection

Do not let the motor labour or slow down through being overloaded in work. When this situation occurs, raise the front of the mower slightly by bearing down on the handlebar, allow the motor to reach maximum speed and proceed to mow at a slower pace. Alternatively readjust to a higher cut position. If the motor continues to labour, switch off and remove the plug from

the mains supply. Remove and empty the grassbag. Examine the discharge chute and remove any blockage. Turn the machine on its side and clear the obstruction from the cutterblade and the underside of the mower deck. Place the machine upright and replace the grassbag. Re adjust to a higher cut position if necessary. Re start the mower and proceed to mow at a pace which does not over the mower.

IMPORTANT: PREVENT DAMAGE - DO NOT continue to operate the motor in an overload condition. If this does occur, stop mowing and allow the motor to run at maximum speed for one minute. This will allow the motor to cool down to its normal working temperature.

Fig. 14

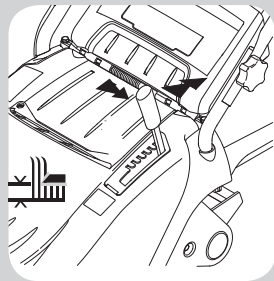

MAINTENANCE SCHEDULE

Maintenance Schedule

Follow the hourly or calendar intervals, whichever occurs first. More frequent service will be required if working for prolonged periods under dusty, dry conditions, when airborne debris is present or after extensive operation cutting tall, dry grass.

Daily

- Clean grass debris from the height of cut ratchet, air filter mesh and the underside of the deck housing.
- Check the condition of guards and safety devices.
- Check condition of cutterblade.
- Check condition of grassbag and ensure airways are clear (replace if damaged).

25 - 50 Hours Or Every Season

- Lubricate wheels, pivot points and linkages.
- Check the cables / switch and connection.
- Sharpen the cutterblade.
- Flash test (Dealer) to ensure complete safety.

MOWER MAINTENANCE

Grassbag

Stop the mower. Remove grass debris from the grassbag immediately after use and check its condition for signs of damage. To prevent accidents replace a damaged grassbag immediately.

(Refer fig.15)

Deck Housing

Remove grass debris from the top and underside of the deck housing immediately after use.

(Refer fig.16)

Fertilisers and top dressings are particularly corrosive. Thoroughly clean the mower deck immediately after use on treated grass and store well away from corrosive materials.

Securing Nuts & Bolts

Regularly check that all securing nuts and bolts are tight. Replace missing or damaged items immediately.

Bolt - Cutterblade fixing torque 20 Nm

Plastic Screws - Bottom of handlebar torque 3.5 Nm

General screws - Used on plastic parts 1.5 Nm

(Note: Use manual hand tools only)

Lubrication

Lubricate the pivot points and linkages with oil every 25 operating hours.

Cutterblade Removal

Stop the mower and turn the mower on it's side.

Firmly grip the end of the cutterblade (2) with a gloved hand and remove bolt (1). When replacing, ensure that the new cutterblade is the correct way up with the turned edges facing towards the motor before locating onto the two carrier pins. Secure the cutterblade fixing nylon bolt and tighten to the specified torque of 20 Nm.

(Refer fig.17)

The cutterblade has sharp edges. ALWAYS wear strong gloves to protect your hands when working on the cutterblade. DO NOT rotate tools towards the cutting edges to avoid the risk of injury should the tool slip. ALWAYS use genuine Hayter replacement parts.

The condition of the cutterblade and its mounting arrangement should be checked regularly for signs of wear or damage. Ensure that the cutterblade is not bent or cracked.

A damaged cutterblade that is out of balance will vibrate excessively and may break. DO NOT use an unbalanced

cutterblade.

Regularly check that the bolt securing the cutterblade is tightened to the specified torque of 20 Nm.

Replace the cutterblade every 2 years or sooner if excessively worn or damaged.

To prevent injury it is wise to seek assistance when turning the mower on its side.

Fig. 15

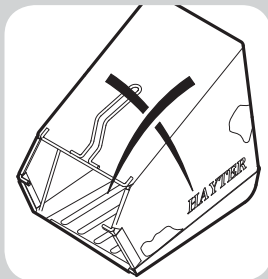

Fig. 16

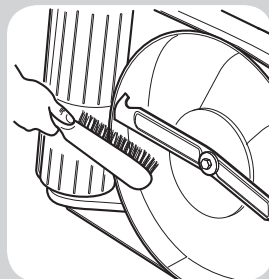
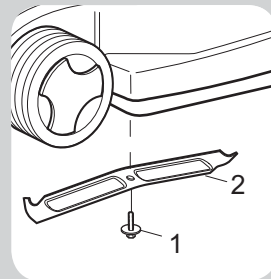

Fig. 17



MOWER MAINTENANCE

Cutterblade Sharpening

A slightly worn cutterblade may be re-sharpened. Both blade edges must be sharpened equally to ensure balance. Sharpen the cutterblade every 25 mowing hours or more frequently if conditions require. Remove the cutterblade from the mower and clean using a brush and water.

Inspect the cutterblade for signs of damage.

Sharpen both cutting edges with a flat file to restore performance. *(Refer fig.18)*

Ensure that the cutterblade is balanced. Use a screw driver with a round shaft to support the cutterblade through its centre hole. Hold the cutterblade horizontal and then release. A balanced cutterblade will remain horizontal.

(Refer fig.19)

If the cutterblade is not balanced the heavy end will rotate downwards. Sharpen the heavy end until the cutterblade is correctly balanced.

(Refer fig.20)

Supply Cable

Check the condition of the supply cable for damage or ageing. Replace immediately if defective.

Storage

To collapse the handlebar, first unscrew the two top securing knobs to allow the top section of the handlebar to pivot forward to rest against the middle section. Unscrew the bottom two securing knobs sufficiently to allow both top and middle sections to be folded forwards.

To ensure that your mower is maintained in good working order, it is important that the following procedure is adopted when the mower is stored for periods in excess of one month. Refer to the 'Maintenance' section as necessary.

Clean all areas of the mower and ensure that the grassbag is clean.

Lubricate the mower.

Treat metal parts with a water repellent anti-corrosion product.

Lower the handlebar if desired.

Cover the mower with a protective sheet and store in a dry area.

Rest the mower deck on wooden blocks to remove the weight of the mower from its wheels/roller.

(Refer fig.21)

CAUTION - PREVENT ENVIRONMENTAL DAMAGE.

(Refer fig.22)

EU Directive 2002/96/EC classifies this product as an electrical or electronic equipment.

(a) These products should not be disposed of as unsorted municipal waste.

(Refer fig.22)

(b) They should be taken to a designated collection point or recycling centre and handled according to national laws in the area.

(c) The consumer has a critical role in returning waste electronic/electrical equipment for recycling and disposal.

(d) Recycling keeps these products out of the municipal waste stream.

(e) The crossed-out bin symbol is a reminder to follow these points.

(f) Please contact your local authority or local dealer and ask for further details regarding the correct method of disposal.

Fig. 18

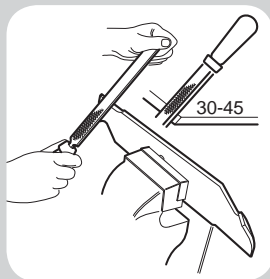

Fig. 19

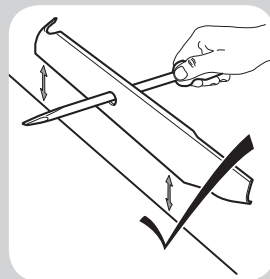

Fig. 20

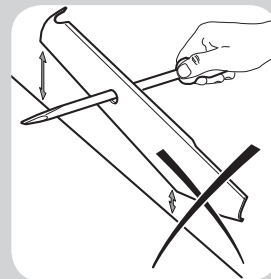

Fig. 21

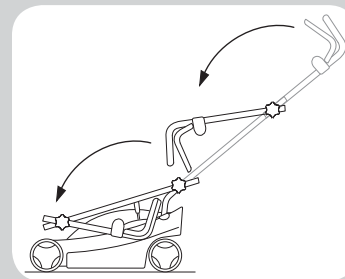
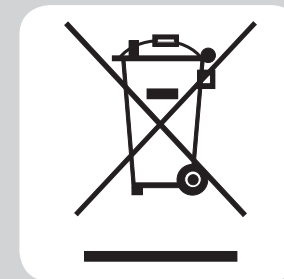

Fig. 22



LAWN CARE CALENDAR To be used as a guide only

January

There is very little work to do this month apart from brushing away leaves. Keep off the grass if frozen or waterlogged.

February

Rake the grass thoroughly. Spike the lawn to aerate and stimulate soil organisms and root growth and apply lawn sand if necessary.

March

The yearly lawn work programme really starts this month. As soon as the ground conditions are suitable, the first cut can be made. The first cut should merely “top” the grass as close cutting at this stage could result in severe yellowing or browning. Two cuts are generally sufficient this month.

April

Mow often enough to stop grass growing away. Dig out patches of coarse grass or resistant weed. Re-seed bare patches.

May

Keep mowing increasing the frequency as required. Treat with selective weed killers or combined weed/feed preparations if you did not feed the lawn in April.

June

Summer mowing should now be under way. It should be necessary to mow the lawn twice a week. Raking before mowing is important this month as the combined action keeps runners of clover under control. Water the grass if necessary, and remember to soak thoroughly.

July

Treat the grass with the second application of fertiliser or weed killer/fertiliser. Water when necessary and rake occasionally. As a general rule the grass clippings should be removed each time you mow. If weather conditions are dry and hot and the grass is weed free, leave the clippings on the lawn to help maintain ground moisture.

August

Keep mowing regularly and watering as necessary. Fill any cracks caused by drought with a mixture of sharp sand and soil. In dry weather conditions leave the grass longer to help retain ground moisture.

September

Raise the height of cut to allow the grass to thicken and protect the roots from the winter frost and snow.

October

Rake out the thatch from the turf and spike the lawn to assist in drainage. Brush in peat and sharp sand.

November

Use a stiff broom to disperse worm casts before mowing. Keep turf free from leaves.

December

Apart from brushing away leaves, December is a slack end of a busy year. Keep off the lawn if it is very wet or frozen.

Lawn Stripes

The way to achieve a neat striped effect is for the lawn being cut in parallel stripes, alternate stripes being mown in opposite directions. A much more important routine is to cut at right angles to the line of the previous mowing. If the work has been carried in a north-south line, then the next cutting should be in an east-west direction. The cross-cutting keeps down the coarse weed grasses.

To prevent grass damage do not remove more than one third of the grass height in one cut.

TROUBLE SHOOTING

PROBLEM	CAUSES	CORRECTIVE ACTION
Motor fails to start	Mains supply socket dead	Test socket by plugging in another appliance
	RCCB tripped	Remove mower plug and check RCCB action. Check the supply cable for any obvious signs of damage and replace immediately if defective.
	Plug pulled out of mains socket	Re engage plug
	Fuse failure	Fit a new amp fuse
	Supply cable damaged	Disconnect from the mains and check the supply cable for any obvious signs of damage. Replace immediately if defective
	Cutterblade obstructed	Disconnect from the mains and remove any obstruction
Motor will not stop	Faulty switch control unit	Ensure that the switch lever has returned to the 'OFF' position. Disconnect from the mains and contact your Hayter dealer
Cutterblade runs on excessively after switching 'OFF'	Faulty brake unit	Contact your Hayter dealer
Motor vibrates excessively	Mounting bolt loose	Tighten bolts
	Cutterblade bolt loose	Tighten bolt
	Cutterblade out of balance	Balance cutterblade
Uneven cut	Undulating ground contours	Change direction of travel
	Cutterblade worn	Sharpen the cutterblade
	Cutterblade out of balance	Balance cutterblade
	Wheels/roller damaged	Inspect and replace as necessary

PROBLEM	CAUSES	CORRECTIVE ACTION
Discharge chute blocks	Grass is wet	Mow dry grass
	Cut height too low	Increase cut height
	Grassbag full	Empty grassbag
	No airflow through the grassbag	Clean the grassbag
Mower is hard to push	Cut height too low	Increase cut height
	Wheels/roller damaged	Inspect and lubricate or replace as necessary
Poor grass condition	No airflow through the grassbag	Clean the grassbag
	Discharge chute blocked	Remove blockage
	Wet grass	Mow dry grass
	Grassbag full	Empty grassbag

WARRANTY

Electric Walk Behind Mower - 2 Year Limited Warranty
Home Owner Use Only
No Warranty offered for Commercial Use

Envoy - Two Year Limited Warranty

Hayter Limited warrants to the original user/purchaser that this unit shall be free from defects in material and workmanship under normal use and service for a period of one year from the date of purchase. To qualify for the full benefit of the warranty, the Warranty Registration Card must be returned to Hayter Limited within 14 days of purchase. If the selling dealer has not returned the Warranty Registration Card please complete and return. Subject to the conditions and exclusions noted in this limited warranty, we shall at our option, repair or replace any part covered by the warranty during the applicable period. If you are in doubt or experience any difficulty, please consult a Hayter Authorised Service Dealer for clarification.

This warranty does not apply to any unit that has been tampered with, altered, misused, abused or used for hire, and will become invalid if non genuine Hayter parts are fitted. This warranty does not cover for minor mechanical adjustments unless they are due to defective material or workmanship. Consult the Owner's Handbook or a Hayter Authorised Service Dealer for assistance when making these adjustments.

Commercial Use
Machines used commercially are excluded from the above warranty.

Making a Claim

To make a warranty claim, return the unit to a Hayter Authorised Service Dealer along with proof of purchase stating the machine serial number and date of purchase. The service receipt(s) or stamped service card must be produced as proof of entitlement to the extended warranty period. Subject to the conditions and exclusions in this limited warranty, the Authorised Service Dealer will, at our option, repair or replace any warranted part within the duration of the warranty period.

This limited warranty gives you specific legal rights and is in addition to any statutory rights to which you may be entitled and your statutory rights are not affected by this warranty. If you need additional information concerning this written warranty, or assistance in obtaining services, please write to: HAYTER LIMITED, Service Department, Spellbrook, Bishop's Stortford, Hertfordshire CM23 4BU

UK ONLY: Details of your local Hayter Authorised Dealer can be found on the Hayter Website www.hayter.co.uk or contact: Freephone 0800 616298.

The Information Hayter Collects

This warranty is jointly administered by Hayter Limited (Hayter) and its affiliate, Toro Warranty Company (Toro). Hayter and Toro respect your privacy. In order to process your warranty claim and contact you in the event of a product recall, we ask you to share certain personal information with us, either directly or through your local Hayter dealer.

Your personal information will be processed by Hayter in the UK. It will also be entered into the Toro warranty system, which is hosted on servers located within the United States where privacy law may not provide the same protection as applies in your country.

BY SHARING YOUR PERSONAL INFORMATION WITH US, YOU ARE CONSENTING TO THE PROCESSING OF YOUR PERSONAL INFORMATION AS DESCRIBED IN THIS PRIVACY NOTICE.

The Way We Use Information

Hayter and Toro may use your personal information to process warranty claims, to contact you in the event of a product recall, to gauge customer satisfaction, and for any other purpose which we tell you about. We may share your information with our parent, The Toro Company, or with our affiliates, dealers or other business partners in connection with any of these activities. We will not sell your personal information to any other company. We reserve the right to disclose personal information in order to comply with applicable laws and with requests by the appropriate authorities, to operate our systems properly or for our own protection or that of other users.

Retention of your Personal Information

We will keep your personal information as long as we need it for the purposes for which it was originally collected or for other legitimate purposes (such as regulatory compliance), or as required by applicable law.

Our Commitment to Security of Your Personal Information

Hayter and Toro take reasonable precautions in order to protect the security of your personal information. We also take steps to maintain the accuracy and current status of personal information.

Access and Correction of your Personal Information

If you would like to review or correct your personal information, please contact us by email at legal@toro.com.

June 11, 2012

NOTES

NOTES

NOTES

NOTES

SERVICE RECORDS & CUSTOMER INFORMATION

Please ensure that upon completion of each chargeable Service you retain your invoice/receipt.

1st Year (12 Months)

We certify that this service has
been carried out by an
Authorised Hayter Service
Dealer

Date: _____

DEALER DETAILS

Date of Sale:- _____

Engine Type:- _____

Engine:- _____

DEALER DETAILS

Serial no. label

Hayter Limited

Spellbrook, Bishop's Stortford,
Hertfordshire CM23 4BU England
Tel: +44 (0)1279 723444 Fax: +44 (0)1279 600338
www.hayter.co.uk